

ASSEMBLY INSTRUCTIONS FOR THE A45/A46 JUMBO & THE R66/R67 JUMBO MOVER

ASSEMBLY INSTRUCTIONS FOR THE A45/A46 JUMBO

1. ATTACH FOOT ASSEMBLIES TO RIGHT HAND AND LEFT HAND LEG ASSEMBLIES. FASTEN WITH 1/4 X 1/2 BOLTS, 1/4 KEPS NUTS.
2. INSERT CUTTER ARM TAB INTO LEFT HAND END OF KNIFE BLADE.
3. INSERT CUTTER ARM TAB INTO RIGHT HAND END OF KNIFE BLADE.
4. FASTEN TOP CHANNEL TO FOOT AND LEG ASSEMBLIES WITH 1/4 X 1/2 BOLTS AND 1/4 KEPS NUTS.
5. PLACE DOWEL ON LEG ASSEMBLY BRACKETS AND CUTTER IS READY TO USE.
6. SCREW OR BOLT DOWN FOOT ASSEMBLY FOR ADDED STABILITY, OR WHEN USING WITH A JUMBO MOVER BASE (R66/R67).

ASSEMBLY INSTRUCTIONS FOR THE R66/R67 JUMBO MOVER

1. INSERT CASTERS IN BASE. FASTEN WITH 1/2 HEX NUTS. USE LOCKING CASTERS IN FRONT, AND SWIVEL CASTERS IN THE REAR.
2. ATTACH FOOT ASSEMBLIES TO RIGHT HAND AND LEFT HAND LEG ASSEMBLIES. FASTEN WITH 1/4 X 1/2 BOLTS AND 1/4 KEPS NUTS.
3. PLACE LEFT HAND FOOT AND LEG ASSEMBLY ON BASE AND FASTEN WITH 1/4 X 1-3/4 BOLTS, 1/4 WASHERS AND 1/4 KEPS NUTS.
4. INSERT CUTTER ARM TAB INTO LEFT HAND END OF KNIFE BLADE.
5. INSERT CUTTER ARM TAB FROM RIGHT HAND LEG ASSEMBLY INTO KNIFE BLADE. PLACE FOOT AND LEG ASSEMBLY ON BASE AND FASTEN WITH 1/4 X 1-3/4 BOLTS, 1/4 WASHERS AND 1/4 KEPS NUTS.
6. FASTEN TOP CHANNEL TO FOOT AND LEG ASSEMBLIES WITH 1/4 X 1/2 BOLTS AND 1/4 KEPS NUTS.
7. PLACE DOWEL ON LEG ASSEMBLY BRACKETS AND CUTTER IS READY TO USE.

BULMAN PRODUCTS, INC.
 1650 MCREYNOLDS NW
 GRAND RAPIDS, MI 49504
 PHONE: 616/363-4416
 FAX: 616/363-0380

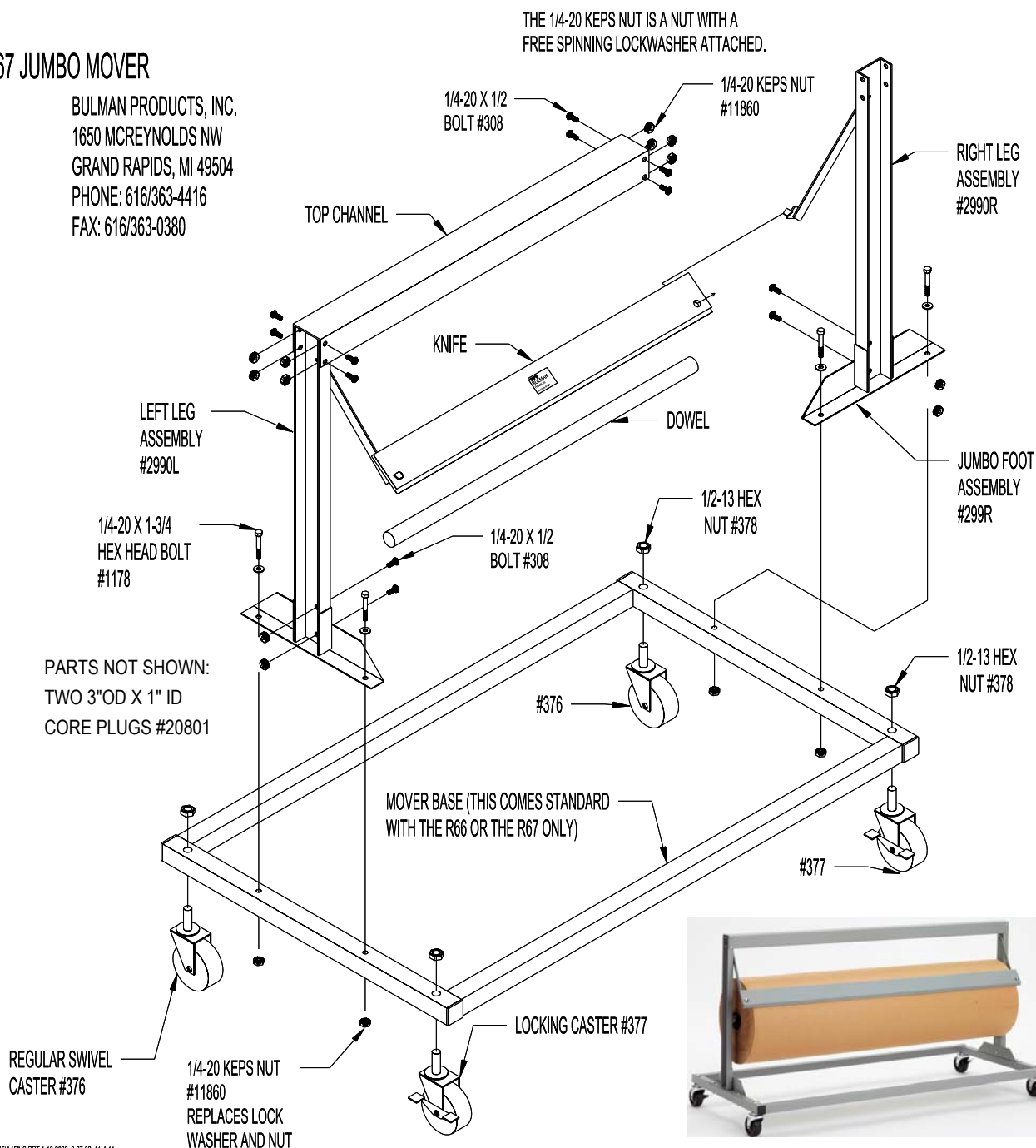

C:\CTA\AS45\ASNS.PRT 1-16-2002, 3:27:02, 11-4-11

TO LOAD A ROLL, LIFT KNIFE UNTIL THE ARMS TOUCH THE TOP CHANNEL THEN PUSH BOTH ARMS BACK TO LOCK THE KNIFE IN THE UP POSITION.