

## INSTRUCTIONS FOR THE R1204 K.D. SUZETTE RACK

1. The rack will be shipped in one box, with three particle board discs and four black cutting stations, four metal dowels, and all the hardware needed to build the unit.
2. To begin assembly, place the top disc (it has laminate on both sides and 16 small holes not drilled all the way through) on a hard surface with the holes facing up. Align the colored dots located on the top board with the dots located on one of the black cutting stations and as shown in Figure 1. Attach the cutter assembly with the hex head wood screws provided. Once secured tightly to the board, the spring-loaded blade will open outward. Attach the other four cutting assemblies the same way as the first
3. After all the cutting stations are securely attached; begin the installation of the five clip stations using the hex head wood screws. (Figure 2)
4. After all the clip stations are attached, place the bottom disc (it has laminate on one side and 16 holes drilled all the way through) on top of the cutting stations with laminate facing down and bolt securely with 1/4-20 bolts, 1/4" nuts, and 5/16" SAE washers provided. (Figure 3)
5. Assemble the bottom paper holders and tighten securely. (Figure 4 on page 2 & Figure A shown at the bottom of this page)
6. Next, attach the swivel plate to the bottom board, aligning the four holes in the middle of the board with the slotted holes on the swivel plate. Fasten the swivel plate with four 1/4-20 bolts, 1/4" nuts, and 5/16" SAE washers. (Figure 5) **NOTE: The swivel plate is not intended to be turned until it has been fully assembled to the rack.**
7. The final step in assembling the unit is to secure the base board (it is not laminated, it has four holes drilled all the way through) with the four 1/4" flat-headed screws using the threaded holes on the swivel plate. The holes on the base board are counter-sunk on one side. These holes should be facing away from the swivel plate and when tightened securely the screw heads should be recessed sufficiently so when turned upright the unit stands flat.
8. Paper can now be loaded. Insert a dowel through the paper roll and then load dowel onto the bottom paper assembly. Push the top of the paper dowel into clip.

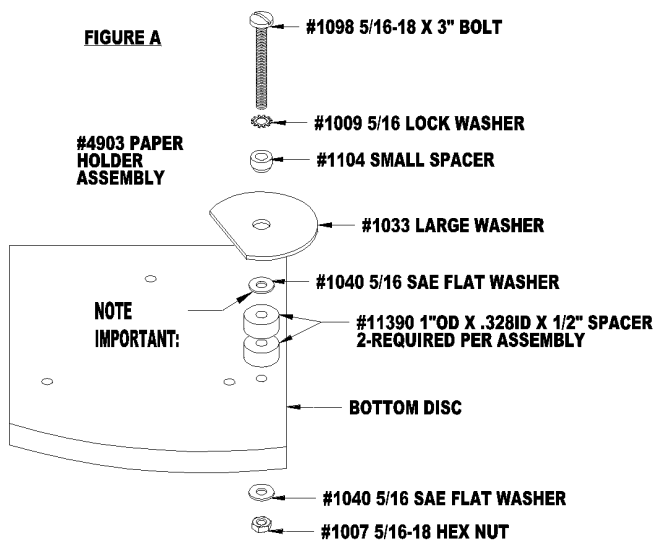

# K-D SUZETTE RACK

## -CLIP STYLE

**BULMAN Products, Inc.**

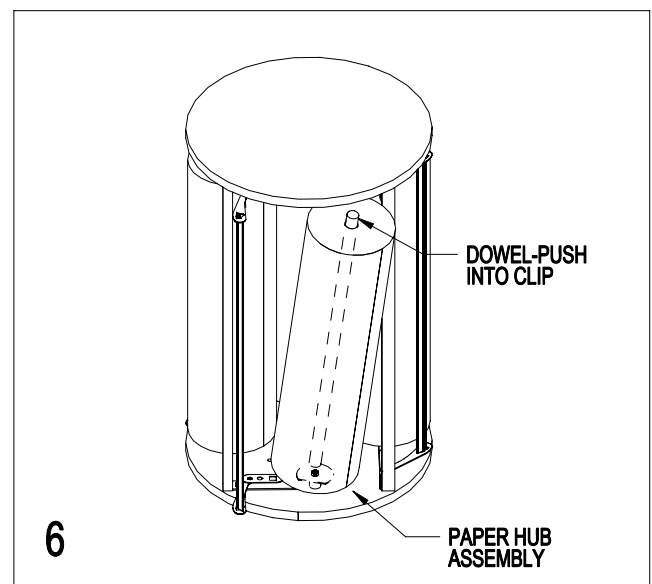
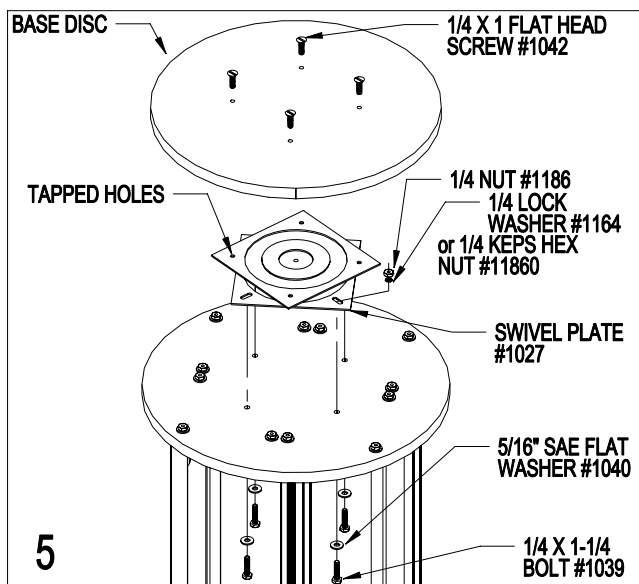
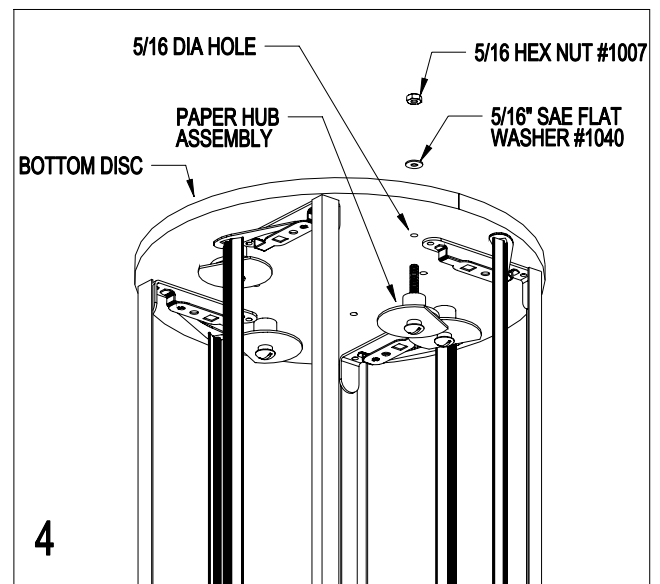
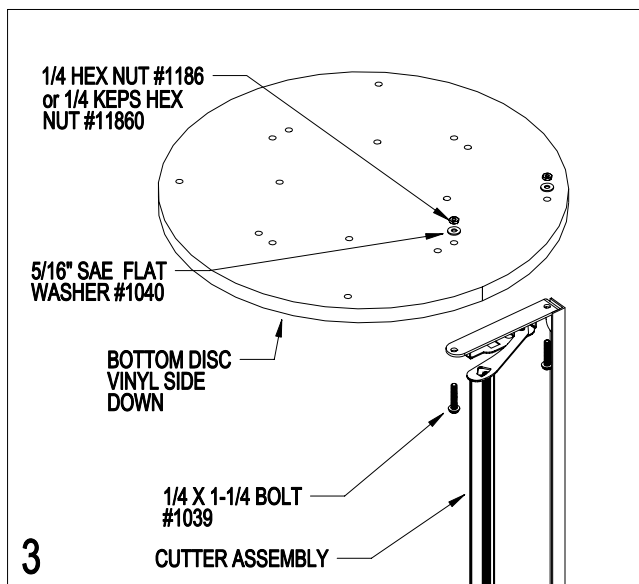
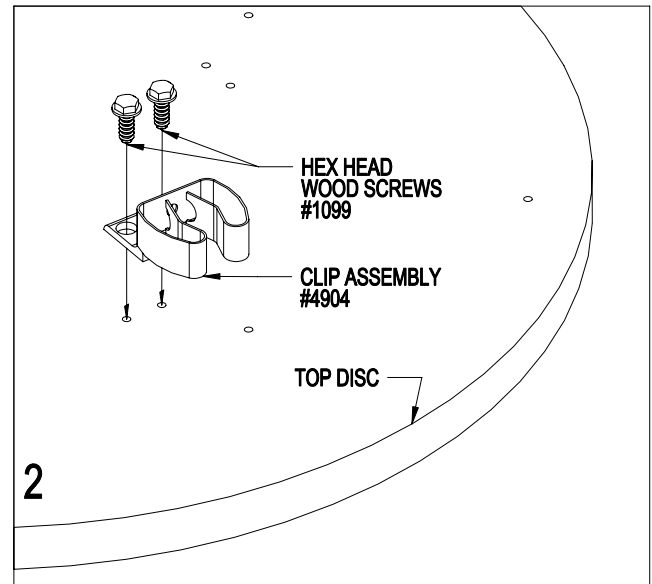
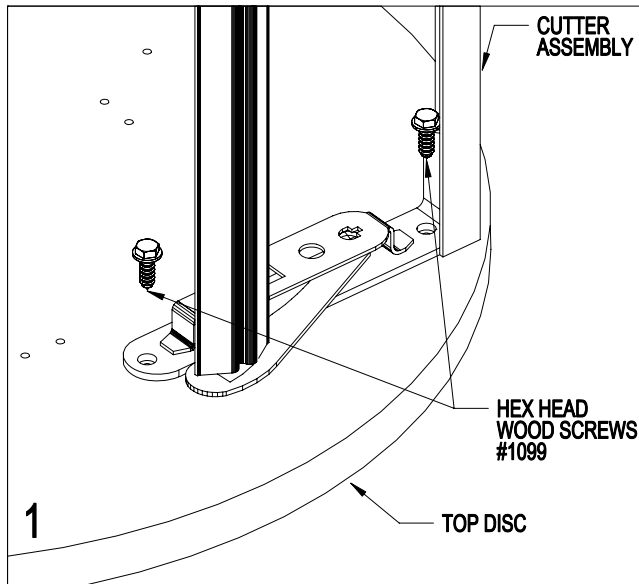
 1650 McReynolds, N.W.  
 Grand Rapids, Michigan 49504-2091  
 616/363-4416, 616/363-4417    www.bulmanproducts.com

**PARTS LIST  
CLIP STYLE K.D. SUZETTE RACK  
R1204 (OAK)**

| <u>PART NUMBER</u>  | <u>QUANTITY</u> | <u>DESCRIPTION</u>               |
|---|-----------------|----------------------------------|
| 1254  | 1               | OAK BOTTOM BOARD                 |
| 1253  | 1               | TOP OAK BOARD                    |
| 1252  | 1               | BASE BOARD                       |
| 1027  | 1               | SWIVEL PLATE                     |
| 4904*   | 4               | CLIP ASSEMBLY                    |
| 4903**  | 4               | BOTTOM PAPER HOLDER ASSEMBLY     |
| 1164  | 12              | 1/4" EXTERNAL LOCK (STAR) WASHER |
| 1186  | 12              | 1/4-20 HEX NUT                   |
| Or 12 #11860 Keps nuts for 12 #1186 HEX NUTS & 12 #1164 LOCK (STAR) WASHERS |                 |                                  |
| 1039  | 12              | 1/4-20 X 1-1/4" HEX BOLT         |
| 1040  | 12              | 5/16" SAE FLAT WASHER            |
| 1099  | 16              | #12 X 5/8" HEX HEAD WOOD SCREW   |
| 1042  | 4               | 1/4"-20 x 1" FLAT HEAD SCREW     |
| 112424B   | 4               | 24" SUZY CUTTER (BLACK)          |
| 1260  | 4               | 7/8" X 25.875" METAL DOWEL       |

**\*EACH 4904 CLIP ASSEMBLY CONSISTS OF:**

|      |   |                                 |
|------|---|---------------------------------|
| 1202 | 1 | BROOM CLIP                      |
| 705  | 1 | #10-24 X 1/2" SCREW             |
| 381  | 1 | #10 EXTERNAL LOCK (STAR) WASHER |
| 380  | 1 | #10-24 HEX NUT                  |
| 1203 | 1 | CLIP ANGLE BRACKET              |

**\*\*EACH 4903 BOTTOM PAPER HOLDER ASSEMBLY CONSISTS OF:**

|       |   |  |
|-------|---|--|
| 11390 | 2 | 1"OD x 1/2"x.328ID Large Plastic Spacer (2 per assembly) |
| 1040  | 2 | 5/16" SAE FLAT WASHER                                    |
| 1007  | 1 | 5/16-18 HEX NUT  |
| 1009  | 1 | 5/16" EXTERNAL LOCK (STAR) WASHER                        |
| 1104  | 1 | 3/8" X 5/8" DIA. SMALL SPACER                            |
| 1033  | 1 | 3-1/4" LARGE WASHER                                      |
| 1098  | 1 | 5/16-18 X 3" MACHINE SCREW                               |